

Wind-resistant Plumb/Holder/Dial Plumb

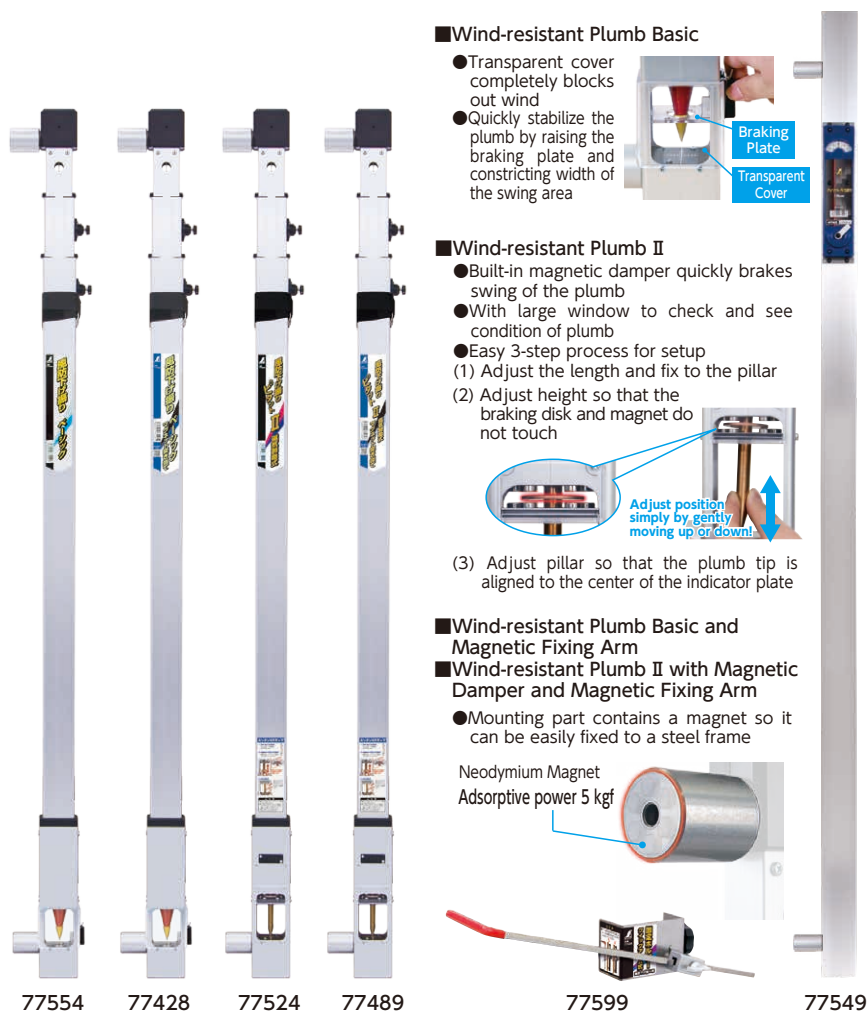

Wind-resistant Plumb

Features

- Spring-loaded reel completely reduces the load on special dual thread and makes it hard to break
- Use when temporary braces are on the supports is also possible since the ends are long (about 40 mm)
- Rubber strap to secure plumb to an object
- Includes a useful carry case

Use

- For verifying perpendicularity of pillars
- For framework construction

Specifications

Item Code	77554	77428	77524	77489
Accuracy*1	±1 mm			
Magnet Holding Power	—	2 kg*2	—	2 kg*2
Material	Rod: Aluminum Drum Cover: ABS resin Plumb: Brass, phosphor bronze, bronze (iron for 77554/77428) End: Aluminum, Neodymium magnet (77428/77489) Transparent Cover: Polycarbonate resin (77554/77489) Transparent Window: Polycarbonate resin (77524/77489) Protective steel plates (77428/77489): Stainless steel Braking plate: Polycarbonate resin (77554/77428)			
Accessories	Exclusive case, rubber band, 2x protective steel plates (77428/77489)			

*1 Accuracy determines the difference between the distance from the upper part end portion to the line in the accuracy confirmation window's position and the distance from the lower part end portion to the center of the indicator plate

*2 When measured with a 3.2 mm thick steel plate

Holder

Features

- Fixing to the pillar is easy
- Attaching and detaching to wind-resistant plumb can be done without tools using the fixing screw

Use

- Fixing the wind-resistant plumb to a pillar

仕様

Compatible Products	Wind-resistant Plumb Basic (77554/77428) Wind-resistant Plumb II with Magnetic Damper (77524/77489)
Compatible Pillar Size	3.5 - 5.5 sun
Material	Body: Stainless steel, aluminum, vinyl chloride resin

Dial Plumb

Features

- Dial model allows one to see fine graduations in slope. No influence of wind.
- Slide arm (end part) is attached, allowing use even when temporary braces, etc. are on the support
- 240 cm when using an extension (77575)
- Includes a useful carry case

Use

- For checking listing of formwork and sash frames
- For setting up of house framework and checking listing supports

Specifications

Item Code	77548	77549	77550	77575
Accuracy	Less than 0.5 mm/1 m			
Lean Tolerance to the Front-back Direction*	±20 mm		±40 mm	
Material	Main Rod, Sliding Arm, Scale Plate, Indicator Fixing Lever: Aluminum Unit Cover: ABS resin Indicator: Steel			
Accessories	Exclusive case			

*Lean tolerance to the front-back direction is the maximum lean in the front-back direction in regards to the entire length of the main scale that can guarantee the accuracy during measurement.

Wind-resistant Plumb

● Parts are listed from p.274

Item Code	Description	Body Size (mm)	Weight (g)	JAN Code	Packing Unit	Packaging
77554	Basic	61×134× 1,515~3,333	3,060	4 960910 775541	1	
77428	Basic and Magnetic Fixing Arm	61×135× 1,515~3,333	3,160	4 960910 774285		
77524	II with Magnetic Damper	64×112× 1,515~3,333	3,120	4 960910 775244		
77489	II with Magnetic Damper and Magnetic Fixing Arm	64×135× 1,515~3,333	3,220	4 960910 774896		

Holder

Item Code	Description	Body Size (mm)	Weight (g)	JAN Code	Packing Unit	Packaging
77599	for Wind-resistant Plumb with Quick Arm	336×110×122	370	4 960910 775992	1	

*For Wind-resistant Plumb

Dial Plumb

● Parts are listed from p.274

Item Code	Description	Body Size (mm)	Weight (g)	JAN Code	Packing Unit	Packaging
77548	110 cm	63×39×1,100	1,500	4 960910 775480	1	
77549	175 cm	63×39×1,750	2,050	4 960910 775497		
77550	200 cm	63×39×2,000	2,300	4 960910 775503		
77575	240 cm	63×39×2,400	3,150	4 960910 775756		