

Folding Square

Carpenter's Squares
Stainless Steel Rules/
Machine Scale
Aluminum Rules
Resin Rules/
Bamboo Rules
Squares/
Protractors
Vernier Calipers/
Micrometers
Tape Measures
Surveying Products

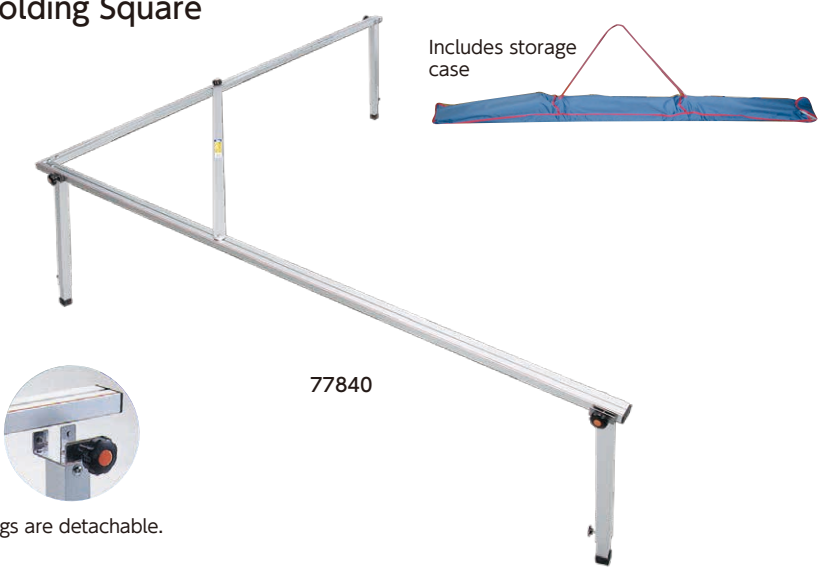

Item Code	Description	Body Size (mm)	Weight (g)	JAN Code	Packing Unit	Packaging
77840	1.8 m	1,823×80×20 (excluding legs)	4,300 (Including Legs)	4 960910 778405	1	

Refer to P. 2 about the shaku scale

Features

- Angle and gradient graduations. Convenient for setting and reading of angle (gradient).
- Detachable legs allow use for layout of leading frames with legs and for marking on foundations or as a bevel without legs. The leg expansion from 50 cm to 80 cm helps use with high ground foundations.

Use

- For layout of leading frames and getting a right angle when marking on foundations
- For marking angle and gradient as a sliding bevel
- Includes storage case

Specifications

Accuracy	90°: Less than 1 mm per 1,000 mm (±1.8 mm at 1,800 mm) Other than 90°: Accuracy not guaranteed Please use as a guide.
Graduation	Angle: 30 - 90° Gradient: 0 - 9/10 (9 sun gradient) Flat Gradient: 6/10 - 9/10 (6 sun - 9 sun gradient)
Body Size	At 90 degrees: 1,823 × 1,823 × 20 mm (excluding legs)
Material	Body: Aluminum Legs: Aluminum, stainless steel

Measuring Instrument Set for Steel Fabrication

Scales
Levels
Lasers/
Optical Equipment
Inclines/
Chalklines/
Plumblines
Circular Saw Guides
Construction Tools
Industrial Tools
Thermometers/
Hygrometers/
Environmental Measuring Instruments

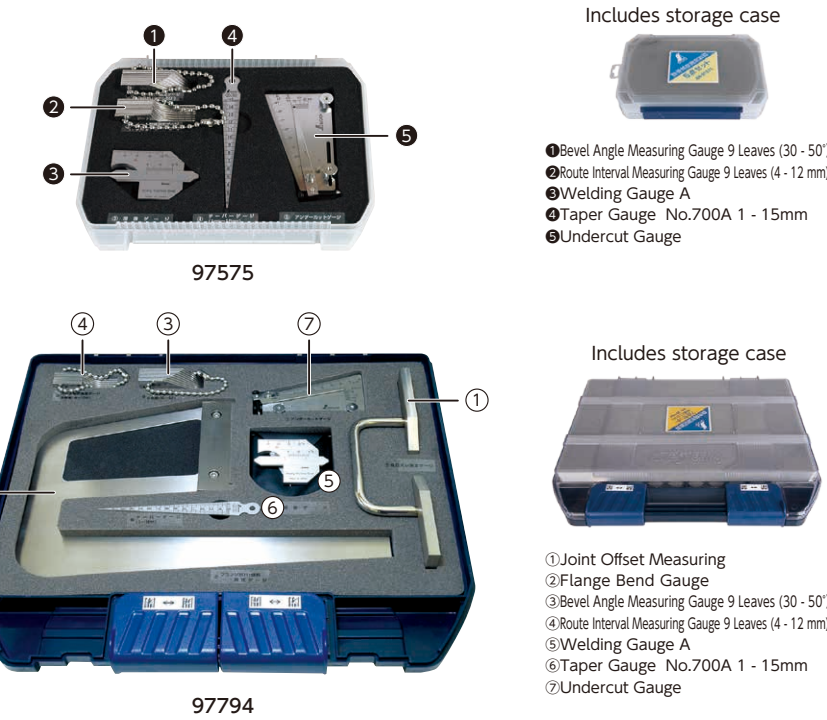

Item Code	Description	Body Size (mm)	Weight (g)	JAN Code	Packing Unit	Packaging
97575	5 Items	234×195×40	870	4 960910 975750	1	
97794	7 Items	425×375×70	3,600	4 960910 977945	1	

As a set (JAN code number is "4960910 + item code + C.D.")

Item Code	C.D.	Description	Example Usage
97788	4	Joint Offset Measuring	Measuring joint offset
97790	7	Flange Bend, Gradient Measuring Gauge	Measuring gap space of flange
97784	6	Bevel Angle Measuring Gauge 9 Leaves (30 - 50°)	Measuring oxygen cutting in manufacture process inspection, bevel angle inspection in beveling edge preparation
97786	0	Route Interval Measuring Gauge 9 Leaves (4 - 12 mm)	Measuring oxygen cutting in manufacture process inspection, route side inspection in beveling edge preparation
* 58691	8	Welding Gauge A	For various welding inspections such as leg length and reinforcement welding
* 62600	3	Taper Gauge No.700A 1 - 15mm	Measuring various gap spaces
* 58695	6	Undercut Gauge	Measuring depth of overlay undercut

*Listed separately

Features

- Convenient gauges for appraisal of steel fabrication are packed into handy kit. Helps to have better productivity and prevents loss.

Use

- For accuracy confirmation of steel frames

Specifications

■ Case	
Item Code	97575 97794
Material	Polypropylene resin ABS resin

■ Gauge

- Joint Offset Measuring (97788)

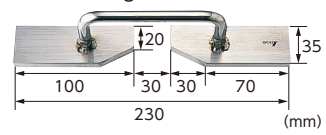

Accuracy	Gap of less than 0.5 mm
Material	Body: Stainless steel
Body Size	65 × 230 × 35 mm
Weight	620 g

- Flange Bend Gauge (97790)



Accuracy	Straightness of less than 0.2 mm, squareness of less than 0.5 mm/140 mm
Material	Body: Stainless steel
Body Size	217 × 335 × 12 mm
Weight	794 g

- Bevel Angle Measuring Gauge 9 Leaves (30 - 50°) (97784)



Accuracy	±1°
Increments	2.5°
Material	Body: Stainless steel
Body Size	30° × 65 × 18 mm
Weight	226 g

- Route Interval Measuring Gauge 9 Leaves (4 - 12 mm) (97786)



Accuracy	±0.1 mm
Increments	1 mm
Material	Body: Stainless steel
Body Size	20 × 65 × 18 mm
Weight	134 g

- Welding Gauge A (58691) (Refer to P. 196)
- Taper Gauge No.700A 1 - 15mm (62600) (Refer to P. 204)
- Undercut Gauge (58695) (Refer to P. 196)